

Jim Lee measure Nch. 9th 1900

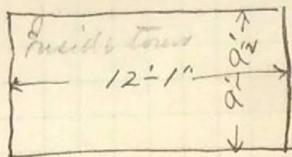

Height of Wall

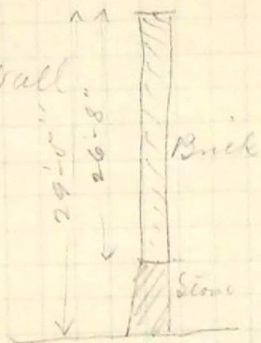

See page 41

For notes of Survey of lands
in Lot 1 Blk. 11 Plat. B. O. C. S.

Surveyed Jan. 1899. and W. Jenkins
Survey (as per sheet inserted page 41)

Case tried in Dist. court in Spring of
1899 - Decree in favor of Jenkins
Survey.

Lines set accordingly for
Lee Gibson Nch 15th 1900 - as per
following notes. Survey helping
meas. from W. Madison S. 1.5 E, at int. ang 90°
hit ctr. of Post SW. cor. Block.
meas. 338.3 feet. Block found Jenkins
note wrong being 670.6 instead of 665.6
so ctr. of block is 5 ft. more
meas. 5 ft. more than 82.5 - ang. 90°
and set nail in place and fence
line hit East of corner boards. Found 5'
Blk 36